



# ADDING SOMETHING SPECIAL TO THE OCCASION

---

## **P Series Liner - P2**

In soft gathers or fitted flat panels gives you options to work your style.

SIMPLICITY · PERFORMANCE · STYLE



## Keeping you covered and adding style

### Fabric

Baytex Liners are manufactured from 100% polyester fire retardant fibre for maximum durability and easy care. All Baytex Silkline fabrics are inherently flame retardant, they have a soft finish with a beautiful silky sheen that resists hard creasing.

### Configurations

Lining sections available as Gable Infills, Mid Sections or Gable End Starters (Gable with Mid attached). Available in either flat or gathered styles. Supplied with all pulleys, halyards and mounting hardware to suit your style of structure.

### Specifications

All linings are supplied in colour coded carry bags. Valances are included as standard.

### Fire Rating Certificates & Flame Retardance

- DIN 4102-1
- AS/NZ 1530;PtsII & III
- NTA 8007:2007 'Brandgedrag van Verseiringsmaterialen' Classification B
- NF P 92-512:1986-M1
- BS5867 Part 2 Type B
- NFPAI 701 (small scale)
- CPAI-84
- New York Board - Bull #44

### Simple Set Up

Load points are locked together with sister clips. A wall cord is incorporated into the eave line for hanging liner walls. Joins between panels are closed with continuous velcro tape. Installation accomplished from ground level. Concealed slots are incorporated in ridgeline for installing light fittings and hanging decor.

### Manufacturing

CAD designed and computer cut for dimensional accuracy. Manufactured onsite at Baytex as for the last 40 years.



Non  
Flammable



Easy  
Care



Machine  
Washable

Silkline FR75 (2 oz)  
for gathered liners

Silkline FR300 (6 oz)  
for flat/smooth liners



**P2 Series** is designed for installation in larger Party & Event Series Structures featuring larger beam profiles with a bay width of 5 metres. Attachment is via a Baytex's unique 'track-hook' system that engages in the keder groove of the structure eave purlin. The regularly spaced track-hooks are set out from the lining's eave line sufficient to allow the valance to sit neatly at the face of the structure leg. For structures that do not have a keder groove feature in the eave purlin, P2 linings have a series of tent hooks set at the eave for attachment to a pre-installed 4mm steel wire eave cable. The ridgeline attachment components are usually installed during tent assembly. The ridgeline is hoisted into position with a halyard cord that passes through a becket at the apex connector and is locked off at the eave of the structure.

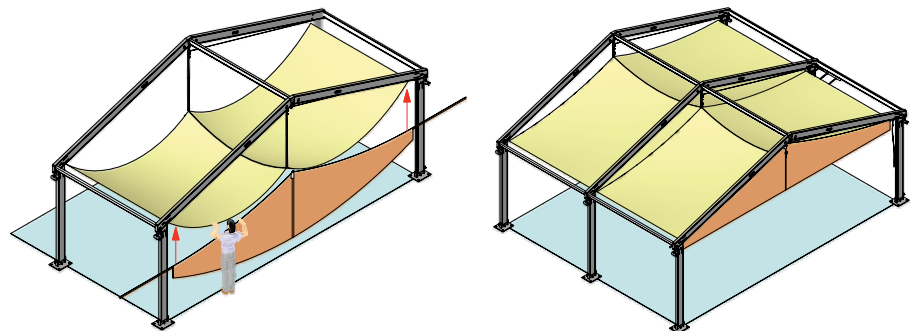
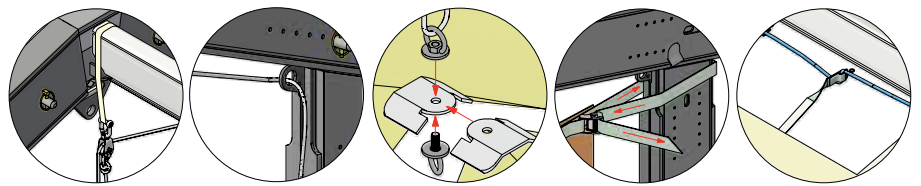

### Lining Accessories

Wall Liners  
Leg Drapes  
Pole Shrouds  
Valance Swags

### Colours



Black



White



Champagne

Non standard fabric colours are available on request.

### New Zealand

52 Newton Street,  
PO Box 4370, Mount Maunganui  
New Zealand

tel +64 7 579 0190  
fax +64 7 579 0194  
www.baytex.co.nz

### Australia

tel 02 4340 4144  
mob 0400 312 314

